



Appendix O

Published Notices and Articles

MOUNTING public resistance to proposed Ruby Road landfill

By STEVE NEWMAN
Weekender Staff

Resistance is rising against the proposed purchase of land to create a new landfill site for Eganville-and-area residents.

The proposal would involve the purchase of 80 acres, of which about eight acres is earmarked for the landfill site. The property is located adjacent to the current transfer station on Ruby Road which was closed as a landfill by Bonnechere Valley council in 2001.

Since area residents heard about the project this past winter, resistance to the possible purchase and creation of a landfill site has been building.

Local residents, which have formed an organization, Citizens for the Preservation of the Bonnechere Valley (CPBV), have been going door to door in the Valley to express their concerns about the proposed project. Group members say they have about 50 members, but expect that number to grow.

Their members include Tony Pearson, a nearby Ruby Road resident, who represented CPBV during a March 4 presentation to council.

Opposition to any landfill site on Ruby Road was evident in such comments as: "We don't want a new landfill anywhere in our township. We don't believe that you should just dig a hole to bury your garbage anymore."

"The Ruby Road dump suggested by the township seems to us (to be) an ostrich's solution, burying its head in the sands of the Ruby Road pit in an effort to avoid seeing the full range of future problems. It is an old and worn-out answer to a new challenge."

Pearson's presentation also showed signs of more than out-and-out resistance, noting the group "would much prefer to work constructively on alternatives which are beneficial, not just for the Ruby and Golden Lake areas or (the former) South Algona, but for Bonnechere Valley as a whole."

Creation of a landfill site, if it happens, will have to happen within the next five years, because that's all the shelf life left at the one remaining landfill in the township, at Sand Lake. Ruby Road and Lake Clear are only transfer stations, after it was found there was leaching from the Lake Clear landfill.

Meanwhile, residents in the former Sebastopol Township part of Bonnechere Valley, in the Highway 41 area south of Eganville, have their garbage trucked to the Ottawa Valley Waste Recovery Centre, off B Line, near Pembroke.

Consultants' report

One solution might be to truck more of Bonnechere Valley's garbage to that same site. That suggestion is among feedback being digested by the township's consulting

sultants, Peterborough-based Cambium.

The company is expected to produce a report in the next little while, says Mayor Zig Mintha.

That report could be back to the waste management committee some time this month, said Bonnechere Valley CAO Bryan Martin.

There were 75 to 100 questionnaires sent in from the public, estimated Martin, knowing some questionnaires were sent directly to the township, some directly to Cambium.

"I would certainly think that was a good thing," said Martin.

"We certainly want public input, but generally you don't get any response until something is in someone's backyard."

Fast-tracking regulation

Because the proposed new property is adjacent to the old landfill site at Ruby Road, that land would be eligible for fast-tracking for a landfill of up to 100,000 cubic metres, according to new provincial regulations, explained Martin.

"The regulations were brought out to help smaller municipalities to expand landfill sites to meet their capacity without having to spend millions of dollars."

"Normally it takes three to five years for (the development of) landfill, but this (property) could be expanded within 24 months."

"I can't even tell you (where we're going with this project)," Mayor Mintha told *The Renfrew Weekender*.

"Right now it's in the hands of our consultants," said Mayor Mintha about the public's response via the questionnaires.

"They're working on questions asked by ratepayers. We have a long way to go."

But not too long, said Mintha, noting it's estimated the Sand Lake landfill will be full within five years.

"We have to do something. The (consultation) process has to take place," insists Mintha.

"We're listening to all sides. When all sides are listened to, it will result in what it results in."

A few weeks after Pearson's presentation to council, he told *The Weekender* that the Citizens for the Preservation of the Bonnechere Valley want to find a new solution.

"Why are we going back to the old technology of digging a hole and throwing your garbage in it?" he stressed. As for costs, Pearson says nobody's saying much about costs because he's been told they're "under discussion." Furthermore, he says he wonders why the County of Renfrew isn't looking for solutions on behalf of all local municipalities.

See **OPPOSITION**, Page 34

"In essence, if they're discussing septage treatment pilot projects in Bonnechere Valley (Horton townships), why aren't they discussing garbage, especially if looking (at the possibility) of conversion," asked Pearson, noting this technology is gaining popularity in Europe.

Members of the CPBV have also gone door-to-door explaining their reasons for op-

posing the proposed landfill site. "I'm not surprised," said Mintha of the reaction. "We don't want (the garbage either), but where do we put it?"

Former Sebastopol Township Reeve Arlene Felhaber, who defeated Mintha to head the first amalgamated Bonnechere Valley council but is retired from municipal politics, is opposed to reopening Ruby Road land to any landfill.

Of the new Ruby Road landfill proposal, Felhaber told *The Weekender*: "I was surprised and I'm almost shocked that they would consider this. We're trying to get away from landfill."

"Even to consider it at this point is really strange to me ... I'm not in favour of opening another problem, and especially with Golden Lake and its proximity (about two kilometres away)."

CLASSE
CUSTC

Visit our website
Email

All Gift Cert
Merchandise

Thank you
I'm proud to have been

Kathryn Bossy, St

Renfrew's
Historic
Theatre

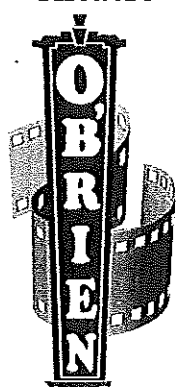

334 Raglan St. S.
432-0866
RW-43 105468

CALLING



OUTS
COMM

Renfrew

ANNUAL

May 7, 20

6:0

Every year the
pays tribute to
a GI

Citizen of the Year
efforts have made

Community Org
profit organization
people in our com

Outstanding Business
a business

success story. Spo

A

Chamber of

Renfrew 1

Renfrew

www.myfmradio

DEADLINE FOR NON

Thursday, April 2

12 noon



Citizens for the Preservation of the Bonnechere Valley

March, 2008

To all those interested in protecting the environment and rural values of our area:

We are a group of local property owners who are very concerned with the proposal before Bonnechere Valley Township Council to develop an 80 acre area on Ruby Road into a mega-dump, to bury all the household and construction waste from the entire Township for the next 25 years.

We oppose this waste disposal, because such landfills are dangerous to the land and water of our neighbourhoods, and could easily affect the whole Bonnechere Valley watershed, to the east and south of Golden Lake. Landfills leak - others in Bonnechere Valley have already done so. The proposed Ruby Road mega-dump is in a populated area that depends on wells, and in addition, is very close to Golden Lake. The homes and the lake, and the quality of life in our area, are in danger.

We believe that there are more modern and better solutions to waste disposal - methods that are more environmentally safe and do not threaten people's water supply and lands, or put cottages and tourist developments at risk from pollution and contamination.

If you too are worried, please take a moment to fill out this form and return it to our organization. Your feedback, and your support for a modern, 'green' answer to our waste disposal problems, are needed if we are to stop this large and menacing new landfill proposal.

Thank you. Also, if you'd like to help in any way, please let us know.



Citizens for the Preservation of the Bonnechere Valley

PROBLEMS WITH LANDFILLS

Landfill – dumping garbage into a waste site pit – is an outdated system for dealing with garbage, and one which presents a number of environmental hazards:

1. Contaminants can leach into ground water, which inevitably flows into our streams, our wells, and our lake. All of the dump sites in Bonnechere Valley to date have leaked.
2. From Golden Lake, the contaminants can be carried downstream – perhaps, through the Bonnechere River system, as far downstream as Eganville and Douglas.
3. Landfills produce methane – a 'greenhouse gas' which contributes to global warming.
4. Landfills can damage local wildlife and eco-systems – not just from the dump itself, but from the new heavy truck traffic bringing all the Township's wastes along Ruby Road to the landfill.

Let's be clear on the facts:

ALL LANDFILLS CONTAMINATE THE GROUND AND WATER
ALL LANDFILLS PRODUCE GREENHOUSE GASSES
ALL LANDFILLS DISPLACE WILDLIFE AND DISRUPT ECOLOGY

..... and once the damage is done it cannot be reversed.

ALTERNATIVES TO LANDFILLS

We don't have to dig a hole and bury our garbage to get rid of it.

1. We can do a lot more with waste recovery and recycling than we do now.
2. The Ottawa Valley Waste Recovery Centre has just been approved for a major expansion of capacity and coverage.
3. Township-scale incineration is being used cost-effectively in Spain and other countries. Incineration means the garbage never gets dumped in a landfill.
4. New technologies promise techniques which can be self-financing. For example, plasma gasification – currently in use in Ottawa – converts waste into clean energy, and leaves a residue of aggregates which can be used to make construction materials.

Waste processing is good business right now for Laurentian Valley. It can become good business for Bonnechere Valley. Just burying garbage is like burying tax dollars.

Landfills no longer make economic or environmental sense. We support conversion of waste – the cost-effective method for turning garbage into a renewable resource rather a source of pollution. We believe waste conversion offers returns to the taxpayer, not another "money-pit" landfill that will cost us all in the long run.

Citizens for the Preservation of the Bonnechere Valley

March 13, 2008

To: Cairine Cybulski
Chair, Waste Management Committee
Township of Bonnechere Valley

Councillor Cybulski:

We wish to inform you of the creation of "Citizens for the Preservation of the Bonnechere Valley", a group deeply concerned about any proposed solution to the Township's waste disposal needs which involves the development of a new landfill. Thus, we oppose the so-called 'capacity expansion' of the Ruby Road transfer station.

At its March 4th meeting, we informed Township Council of our purpose and of our recommendations for an improved consultation process. As you were absent from this meeting, we append a copy of what we gave Council. At the meeting, Mayor Mintha declared that the next consideration of the Ruby mega-dump landfill proposal would be at your committee. Therefore we would like to request the following from the committee:

- a) notice of all meetings of the committee, as well as any other meetings at which the creation of a new landfill at Ruby or any other site might be discussed;
- b) a copy of the full terms of reference for the study being carried out by Cambium Research, as well as a statement of the total cost of this study (or studies);
- c) (when available) future reports from the Cambium project, including their analysis of the consultation and the questionnaires completed as a consequence of this consultation;
- d) a copy of all Township-funded research on the future of waste disposal in Bonnechere Valley, along with the cost of such research.

We would also repeat our requests to Council for broadening the scope of consultation, namely:

1. a further survey of opinion about the proposed new Ruby landfill, along with other waste disposal options under consideration.

We believe that this survey should be included with the Township's mailing of assessments (tax bills). We'd like to assist with the wording of this survey, to ensure it elicits a full range of informed feedback on the waste disposal problem.

2. additional public consultations beyond the November meeting mentioned in the Cambium report, including meetings in South Algona ward, and meetings during the summer months, when seasonal residents are present.

3. addition of two representatives of "Citizens for the Preservation of the Bonnechere Valley" to the public liaison committee on waste management.

4. creation of a further sub-committee to investigate alternatives to landfills, which would issue invitations for people to present research on such alternatives.

1/10 late
We further recommend that no further spending or preparation work on the proposed Ruby landfill take place until this sub-committee has an opportunity to report its findings. In fact, we recommend that no further steps to develop the Ruby 'capacity expansion' be taken until another round of public consultation has taken place, both by the Waste Management committee and by full Township Council.

We look forward to your response. In your position as the South Algona representative on Council, we are relying on you to keep us fully and promptly informed on all aspects of the Ruby mega-dump landfill issue. We also trust that in your position, you will support the expressed wishes of the people of South Algona, determined through an expanded consultation process, when decisions on the issue are made.

We also repeat the pledge we made at the March 4th Council meeting, to work with the Township on research and development of non-landfill options for Bonnechere Valley's waste management needs. We have volunteers with the expertise and the commitment to undertake such work. We look forward to a collaborative solution.

Tony Pearson

R. Zantow

FOR "CITIZENS FOR THE PRESERVATION
OF THE BONNECHERE VALLEY"

Citizens for the Preservation of the Bonnechere Valley

Membership Form

YOUR CONTACT INFORMATION:

Name: _____

Mailing Address: _____

Phone Number(s): _____

E-mail address: _____

I am a local resident ☐ summer resident ☐
local business ☐ concerned citizen ☐

I prefer to be contacted by: phone ☐ mail ☐ e-mail ☐

CPBV mailing address: c/o Roberta Barrow, membership chair
1760 Wolfe Road, RR 4
Killaloe, Ont. K0J 2A0

Citizens for the Preservation of Bonnechere Valley

RUBY LANDFILL FACTS



THE PROPOSAL – A NEW GARBAGE DUMP NEAR GOLDEN LAKE

The Township of Bonnechere Valley is looking for a long-term, low-cost solution to its waste disposal needs. Therefore it is proposing to dig a new landfill on an 80 acre site west of the now-closed Ruby dump. It claims that only 7.5 acres will be needed for the new landfill. It further claims that the site provides the perfect conditions for "natural attenuation" — that is, the environment will absorb all leakage of damaging chemicals and toxic substances (called 'leachate'). The Township believes that there is no risk to

area surface or groundwater (including wells), and no threat of contaminating Golden Lake in any of the 25 years that they propose to keep this new dump open. The Township also claims that there is no possibility of environmental damage. Accordingly, there are no plans for leachate containment, capture, or treatment. They have hired a Peterborough engineering firm, Cambium, to a contract amounting to several hundred thousand dollars, to oversee the approval process.

CONSIDER THE PROPOSED NEW RUBY LANDFILL / DUMP

- It is within one and a half kilometres of Golden Lake.
- It is to be an "old-fashioned" landfill — that is, the pit will not be lined, and there will be no capture or treatment of leachate (leakage). Leachate can contain mercury, cadmium, arsenic, and a host of other toxic chemicals and contaminants.
- The threat to the area would increase if, as suggested, construction materials and debris are also sent to this new dump.
- All dumps, even the safest most modern ones, leach after a period of time — 100% of them, according to Environment Canada.
- All landfills within Bonnechere Valley Township have already leaked to some extent.
- The cost of a new landfill (even an old-fashioned one) is not going to be cheap. Land must be purchased or leased, new equipment bought, and on-going monitoring set-up. A township study put the conservative capital and operating costs at hundreds of thousands of dollars per year, for decades to come.
- Should the monitoring process find that the dump is in fact leaking, the extra costs of clean-up could be very high, and a real burden to the taxpayer.
- Golden Lake contains numerous cottages and many businesses — a number of them geared to the tourist trade. These properties produce a lot of tax dollars for the Township, and the businesses help the Township's economy quite a bit. But tourists and new home & cottage buyers tend to react negatively to the idea of a nearby dump.

ARE THERE ALTERNATIVES? YES!

- Laurentian Valley Township operates a high-volume, up-to-date waste treatment facility nearby (Ottawa Valley Waste Recovery Centre on Waito Station Road, near Rankin.)
- This waste recovery centre is currently constructing a leachate capture and treatment facility.
- Bonnechere Valley is already a partial partner in this facility, and could become a full member.
- The cost of joining the Ottawa Valley Waste Recovery Centre appears to be about equal to (or even less than) the cost of building a new landfill at Ruby.
- Plasma gasification of waste — which converts garbage into saleable commodities like electricity and aggregate — is on its way here; Ottawa looks likely to go this route, and Renfrew is now looking into it as well.
- The Township already owns and is operating a 50 acre landfill site which is apparently well short of capacity — which should give time for more consideration of more modern alternatives.

THE DEBATE :

Cambium and the Township contend that the new Ruby landfill will be safe, and that during the screening process, no alternatives should be considered. The Citizens for the Preservation of the Bonnechere Valley ask: "Why dig an old-fashioned — and dangerous — hole in the ground to dump waste into when better, safer solutions are available?"

WHAT DO YOU THINK?

You can express your view on this proposed new landfill at a public meeting which has been called for Saturday, July 26th, at 10 AM at the Legion ballfield park in Eganville.

AREA OF PROPOSED NEW LANDFILL

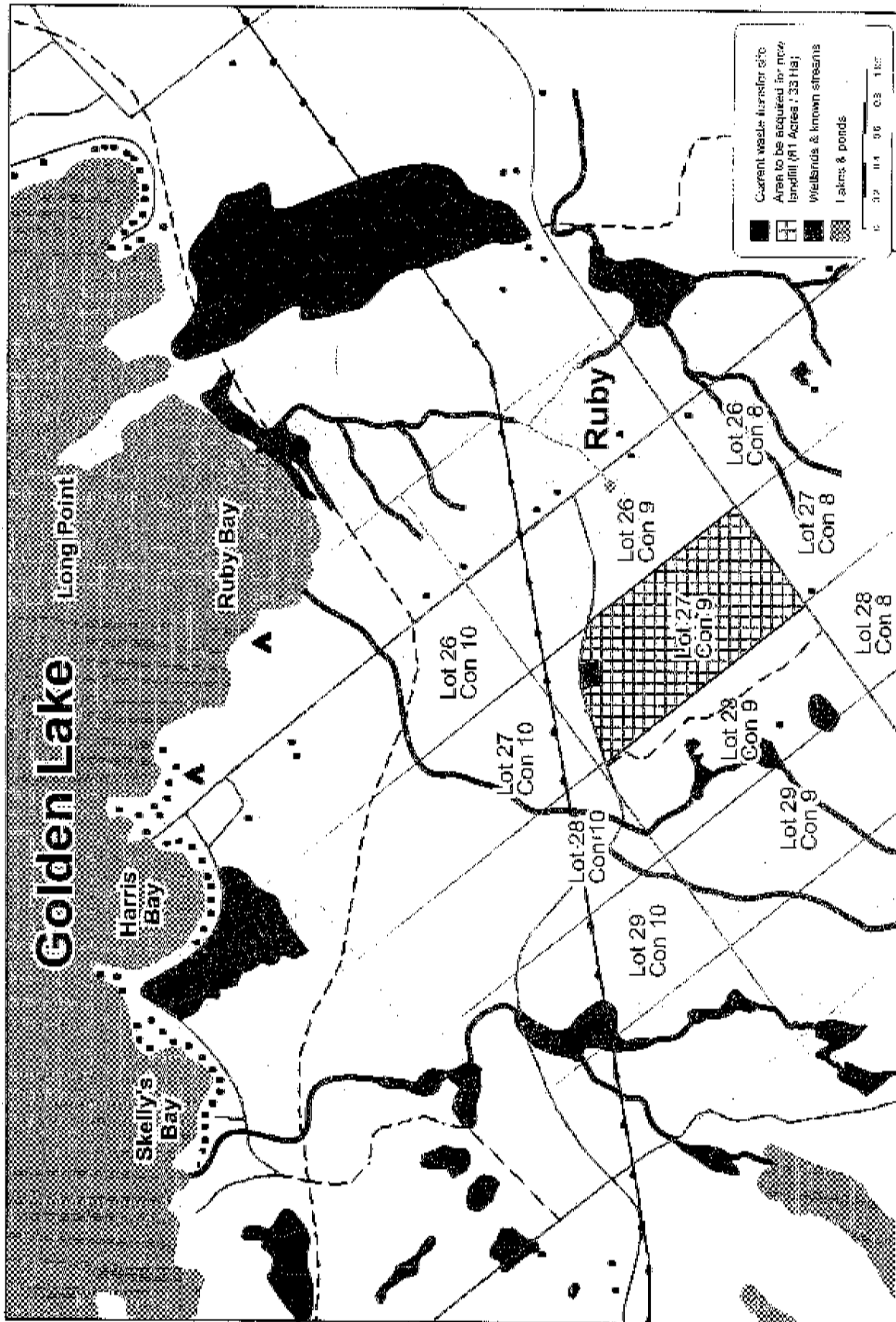

Citizens for the Preservation of Bonnechere Valley

CPBV NEWSLETTER

MAY 2008

Make waves...



YOUR LAND, YOUR WATER, YOUR CONCERN

Welcome to the first edition of the CPBV newsletter! We hope that in months to come, this little grass-roots publication will help keep CPBV members and concerned citizens informed about the happenings surrounding Bonnechere Valley Township's proposed Ruby Dump "Expansion" (actually, a brand-new dump.)

The Township has hired a consultant to write public relations press releases about the

landfill for all the Township's garbage. We are worried, because of unanswered questions about the effect on the land — your land. We need to know about the potential harmful effects of a large new landfill such as:

- ground and surface water contamination
- loss of air quality
- noise pollution
- risk of fire
- disruption and displacement of wildlife
- negative impacts on tourism

"Moisture and water can filter through the [garbage], picking up metals, minerals, organic chemicals, bacteria, viruses and other toxic materials. This contaminated water is called leachate. If the leachate is not contained, it can travel from the site and contaminate our ground and surface water."

Modern landfills are engineered to meet strict rules and standards to collect and treat leachate."

So, is the Township planning to capture and

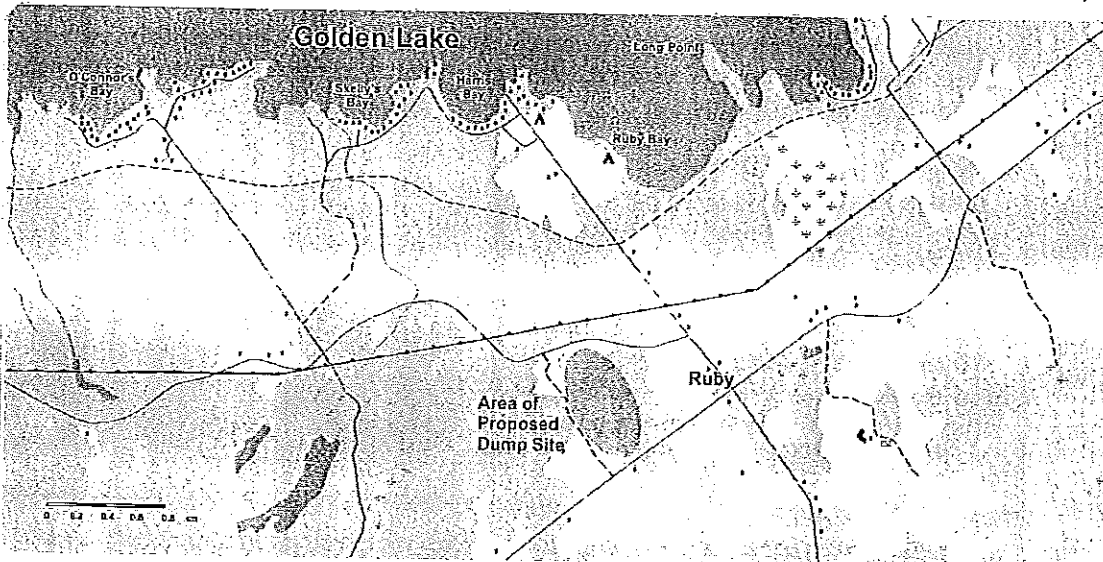

advantages of the new Ruby dump. This newsletter is an effort by concerned local property owners to cut through some of the hype and ask essential questions about efforts to minimize damage to our land and our water.

We also hope to explore some alternate, "greener" solutions to waste disposal over the next several years.

WHY WE'RE WORRIED AND WHY YOU SHOULD BE...

The Township of Bonnechere Valley plans to purchase 80 acres behind the current Ruby Road waste transfer site and turn it into a

We think that an old-fashioned landfill poses a threat, not only to local wells and to property values in the area — but potentially to Golden Lake. The goal of our organization is to encourage a shift to a better, safer solution than just a hole in the ground.

IF IT LOOKS LIKE A DUMP, IT WILL LEAK LIKE A DUMP...

The Township, through its agent Cambium Engineering of Peterborough, is claiming that this is to be a "modern" landfill. What does that mean? According to the Ministry of the Environment's web page regarding landfills:

treat leachate — the poisons leaking into the ground and water? Well, no. They have stated that they don't plan to do this at all. So we don't know how it can be claimed that this is anything other than the old-fashioned "hole in the ground."

John Desbiens, president of Cambium, has admitted that there will be a leachate plume but there are no current plans to deal with it other than letting the Ruby environment handle it as best it can. We think the public must ask if Council is aware of the Ministry of the Environment's Clean Water Act, which requires municipalities to develop plans to protect source water.

Get Involved,
Stay Informed

CPBV MEMBERSHIP IS ABSOLUTELY 100% FREE!
JUST STAY INFORMED, OR JOIN THE FIGHT TO KEEP
BONNECHERE VALLEY CLEAN! ALL ARE WELCOME!

e-mail: CPBVmembership@gmail.com
phone: 613-625-2227

A clean and safe environment is everyone's concern!

Make waves...



TRASH TALK : HAZARDOUS MATERIALS

One way to reduce the potential harmful effects of a landfill is to ensure that nothing dangerous gets into the landfill – no cadmium from batteries, no arsenic from electronics and treated lumber, no formaldehyde from plywood, no mercury from light bulbs.

Did you know that the new "long-life" compact fluorescent bulbs we're being urged to use in our lamps contain a significant amount of mercury?



So we'd like to know how the Township is planning to keep such substances out of its new landfill. In modern landfills, all garbage is inspected for hazardous substances before it's dumped in the ground. As far as we know, the Township doesn't have any plans to do such inspection. They want us to trust that it won't happen. When the future of Golden Lake and the Bonnechere Watershed is at stake, we think this is too big a risk.

SIZE MATTERS

In Cambium's public relations material, The Township states that it only needs seven and a half acres for the landfill. Yet they plan to buy 80 acres. They say this is only for protection. But if the landfill is as safe as they claim, why do they need so much of a buffer zone?

They also claim that "it would be very short-sighted" to take additional waste from outside the Township in future. Yet who's to say that a future Town Council won't be tempted to get themselves extra money by selling off space, so that Ruby becomes a dumping ground for larger towns and cities? If they only need seven acres for 25 years, then there's a lot of space left over. And a lot of places would love to ship their garbage to someone else's front door.

LETTERS TO THE EDITOR : SHORTSIGHTEDNESS OR WHITEWASH?

"It seems that Bonnechere Valley council will, once more, miss the boat!"

First time, was not joining the group at Laurentian Valley (OVWRC) a few years ago. Reason: 'It was too expensive.' Now we (the taxpayers) have to purchase or lease land (this is not clear yet) so that we can make another 'Sand Road Landfill.' We all know the condition [the Sand Road landfill] is in. The cost of joining OVWRC has increased dramatically, so we get the usual 'It's too expensive' again. The door is still open but our council seems a little misguided and is balking again.

When the landfills have leachate and they do, they need to be cleaned up at great cost. Are the citizens of Bonnechere Valley ready to dig even deeper into their pockets to pay for this? Did the council even ask what the citizens thought about this possibility? I don't think they did. Or is this whole project a case of consultants (Cambium) whitewashing Townships into thinking that this is the way to go?

It is old fashioned technology : burying garbage and covering it daily, in a big hole. This proposed site is 7½ acres. The land it will be on, the other 72½ will be worthless as it has a GARBAGE DUMP IN THE MIDDLE OF IT! You may be able to disguise it with grass and shrubs but it's under there for sure! So whoever owns it will be solely responsible for any clean up that is necessary. Are you ready for that?"

TBV taxpayer

If you would like to speak your mind, please email your thoughts to
CPBVmembership@gmail.com

UPCOMING EVENTS

Thanks to the urging of our group, there will be an additional public consultation to allow summer residents to have a say on this issue. The meeting will be held at the Legion field in Eganville on Saturday, July 26th at noon. If you have any concerns or questions about the proposed new dump, you owe it to yourself to attend.

NEXT ISSUE

Coming up in our June newsletter, we will be examining some of the "greener" solutions our township is rejecting.

WEB LINKS

SOME INTERESTING READING...



MOE Landfills — <http://tinyurl.com/4fscix>
CWI solid waste — <http://tinyurl.com/5u2zm3>
Water contamination — <http://tinyurl.com/5ynj9n>
Arsenic leachate — <http://tinyurl.com/4vxtfp>
Landfill contaminants — <http://tinyurl.com/4jecnw>
MOE Clean Water Act — <http://tinyurl.com/3h29mr>
MOE CWA Fact Sheet — <http://tinyurl.com/4o6uuz>
Clean water for ON — <http://tinyurl.com/6j2yxk>
Species At Risk registry — <http://tinyurl.com/6adjez>
MNR SARA — <http://tinyurl.com/62wqmo>
COSEWIC — <http://tinyurl.com/4nrti8>
Ottawa V. Waste Recovery — <http://www.ovwrc.com>
Plasma Gasification — <http://tinyurl.com/4n24js>
CELA — <http://www.cela.ca/>
E-Laws — <http://www.e-laws.gov.on.ca/>
Stop Dump Site 41 — <http://tinyurl.com/49m328>
CLEAN — <http://tinyurl.com/4gvd6a>
Ruby topography — <http://tinyurl.com/5s8xy6>
Ruby land use (PDF) — <http://tinyurl.com/4nzyp9>
John Baird, MOE — <http://tinyurl.com/4dogwn>

Get Involved,
Stay Informed

CPBV MEMBERSHIP IS ABSOLUTELY 100% FREE!
JUST STAY INFORMED, OR JOIN THE FIGHT TO KEEP
BONNECHERE VALLEY CLEAN! ALL ARE WELCOME!

e-mail • CPBVmembership@gmail.com
phone • 613-625-2227

Message to the Ratepayers of Bonnechere Valley Township

In her recent statement on the Township's waste management deliberations, carried on the Leader's editorial page, Councillor Cybulski presented a report laced with inaccuracies. Given that the landfill issue is so vital to the people of South Algonia, I'd like to correct some of Ms. Cybulski's misleading statements.

Unlike the open approach of its neighbouring township, Bonnechere Valley Town Council first made up its mind that a new landfill on Ruby Road was the answer. They spent several hundreds of thousands of dollars, paying a consultant to make the case for the new dump. As for not spending money on the Ruby site itself Council has twice paid the land-owner for an option to buy. The initial public meeting of February 2008 saw the Township and its hired public relations agent come out four square in favour of this dump as the only viable option. Following this meeting, at the Public Liaison Committee, Councillors Cybulski and Buckwald joined with Cambium president John Desbiens to act as the advocacy group on behalf of the new landfill, as the environmental screening report was put together. This is totally unlike the approach which is being followed by Killaloe-Hagarty-Richards, where no option has been recommended prior to the review process.

Contrary to Councillor Cybulski's claims, it was the public that demanded the Ottawa Valley Waste Recovery Centre be considered as an option. If it wasn't for the property owners and rate-payers of the Golden Lake/South Algonia area, the Township would still be attempting to claim that the new dump was the only solution. Thus, at the first public meeting, Cambium's presentation greatly exaggerated the costs of the Waste Centre option, just as they greatly understated the likely costs of a new dump. The township then put out a newsletter advocating the new dump as the only answer. But the public wasn't buying; on the Township's own questionnaires, about three-quarters of respondents stated that they didn't want a new dump. And on a further questionnaire, over 90% said they had little or no confidence in the Township's screening process.

As it stands, although Council has been asked for figures on the comparative costs of the two options, none have been forthcoming, even though Council promised them 'as soon as they were available'. Cambium apparently prepared dump estimates last fall, and Ottawa Valley has given its cost figures, yet no figures have been released. Moreover, Councillor Cybulski has muzzled the representatives of the Waste Recovery Centre, forbidding them to talk to the public or to anyone but members of Council. This is hardly the 'transparent' process that Cybulski claims, in fact, it is the opposite. Until the public has a chance to see the figures and examine their validity (given previous costing errors), this is very much a 'behind-closed-doors' exercise on a matter of great importance to rate-payers, and to property owners in South Algonia and on Golden Lake, whose property values may be threatened by a new landfill on their doorstep.

So where are we really at? We were told last winter that Cambium's environmental screening report in support of the new landfill was being submitted, and would be approved in a month or two. Then we learned that only the first stages of the report were submitted, and the Ministry of the Environment asked for additional research on water quality issues. Councillor Cybulski insists that MOE is OK with the proposed new dump. Their hesitation suggests otherwise. They are very aware of what developed in Simcoe County, where a proposed dump on top of an aquifer raised so much concern that eventually, the site was barred and the landfill project abandoned. Since the proposed new Ruby dump is also situated on top of an aquifer which supplies local wells, and feeds streams which empty into Golden Lake, we can understand the Ministry's reluctance to rush through an approval.

It is time for Council to release cost figures and allow public debate on the issue once again. Their silence heading into an election suggests that either they have something to hide, or they are just waiting for the election to be over before going ahead with the option they initially recommended - namely, a new landfill, unprotected by either a liner or a toxic leachate capture and treatment system - an accident just waiting to happen. I believe that the Waste Recovery Centre presents a much safer and affordable alternative. And when new waste technology is advancing so rapidly, why would Bonnechere Valley want to be stuck for over two decades paying for an old-fashioned option?

More important, I believe that the issue should no longer be hidden, but returned to public discussion, with full disclosure of all relevant information, so that the public can again have its say.

Bob Harris,
candidate for Council for South Algonia

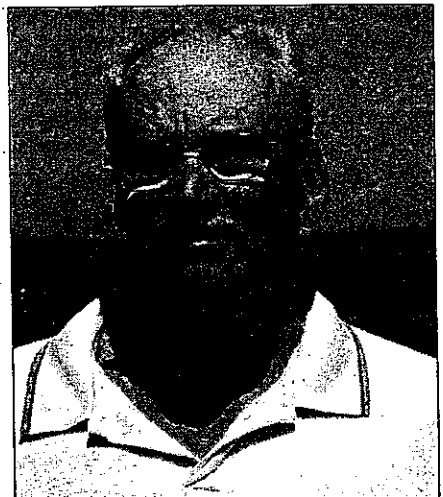

BV Township figures are challenged again

The Leader, Eganville, Ontario - September 22, 2010

Dear Editor:

Let's get one fact straight right away: the figures which Cambium developed on the costs of the two options for waste disposal are inaccurate – as in, wrong. The figures for the cost of transporting our garbage to the Ottawa Valley Waste Recovery Centre are inflated by a factor of more than double, and in the case of capital costs, by a factor of five times.

When you do the math, the OV option is actually no more, and may actually be less, than the cost of the township building its own new landfill. Therefore, to choose the Ottawa Valley option would not cost taxpayers any more than a new dump in South Algonia.

So if there's talk of misleading the public, to develop the case for a new dump, and since they would add a new dump to the sites they are paid to monitor for the township, they would seem to have a vested interest in seeing that the new dump is approved. (Last year, I urged town council to get the costs prepared by a neutral firm; they rejected this option.)

For openers, there are different costs given for the same thing – a good reason for doubt. In the itemized costs, Cambium gives the total figure for joining OV as around \$14 million. One page later, the figure has jumped to \$24 million – a sudden \$10 million increase, with no explanation!

Cambium claims that the capital costs of joining OV would be over \$5 million – wrong. As I understand it, the new inter-municipal agreement means the buy-in cost covers all of the existing facilities. There is no extra cost for gas capture and leachate treatment system which has been installed; it's already in the 'cover charge'. The massive closure costs cited are in reality part of operating costs, which are more than covered by revenues. So the capital cost is actually about \$1 million. This is half the cost of what Cambium says it would take to build a new dump.

Cambium says that the annual operating costs at OV would be over \$800,000 a year – wrong. I checked their website (www.ovwrc.com). We would pay \$75 a tonne in tipping fees; if the township sends about a

thousand tonnes of garbage a year, that's \$75,000 a year – less if we all learn to recycle more. In addition, we would pay about \$200 a load in haulage – less if the township used or contracted its own trucks – for an additional \$30,000 a year (again, less if we learn to recycle more). Finally, royalties would cost about \$4.50 per capita, or a little less than \$20,000 a year. That totals well under \$200,000 a year, or about a quarter of what Cambium says it would cost. Again, the sum would be less than even Cambium's rock-bottom cost for operating a township landfill.

As for all the other operating costs mentioned, these are more than covered by OV revenues. So the claim that the township would have to pay about \$35,000 a year seems to be bogus. In fact, for three of the past four years, OV has paid its partner municipalities dividends out of its profits – a new revenue gain for the township, not an expense.

On the other hand, Cambium appears to have underestimated the costs of building a new dump. They are currently planning for an unprotected landfill – but if the Environment Ministry requires more protection, like a liner or leachate processing, the capital costs will go up substantially. Apparently it will be supervised by one part-time staff person, which hardly seems adequate. And the operating costs don't seem to cover insurance fees, let alone contingency fees to offset the massive costs which could result from leaks.

Various municipal politicians are saying "trust us". They express outrage that people would question the process. But how can such trust be granted when the figures produced are so obviously in error?

If council and Cambium still believes my calculations are wrong, why don't they ask the OVWRC to comment on the accuracy of the figures they attribute to them. Is council willing to do so, and to make the reply public? If not, where is the trust?

Roger Imhof,
member of the Bonnechere Valley
Public Liaison Committee,
R.R. 4, Killaloe

Page 8

Letters

Bonnechere Valley has the opportunity to join OVWRC

Dear Editor:

In the Sept. 15th edition of the *Leader*, Mayor Zig Mintha commented on the current waste disposal debate, stating that "the cost and the environmental issues are very important to everyone." I couldn't agree with him more. The problem is, cost and environmental issues are frequently at odds with each other, and there is a huge difference between solutions that are cheap in the short-term, and solutions that are safe and cost-effective in the long-term.

If Bonnechere Valley decides to commit to a new dump of our own, all costs are exclusively ours, for decades to come. Should MOE guidelines tighten and new equipment/facilities be needed, or, should an environmental mishap occur and require clean-up, that expense must also be borne exclusively by township ratepayers. Joining Ottawa Valley Waste Recovery Centre though would distribute such costs across all of Pembroke, Patawawa, Laurentian Valley, North

Algonia/Wilberforce, and Bonnechere Valley (with costs per town/township being proportional to each member's population, of which Bonnechere Valley would be a tiny fraction.) I'll also mention that small dumps are being closed in the province of Quebec, so do we really want to consider investing in a solution that runs the risk of being closed prematurely should Ontario follow suit?

I'm not sure that people are aware, but we are in a unique situation due to our current ties with the OVWRC. Bonnechere Valley has an opportunity to join the OVWRC -- should we refuse it, the space will go to someone else, and we may never have another opportunity. In the not-too-distant future, we will choose between creating our own marginal facility, or becoming part of a larger, progressive facility with significant financial backing.

The township's environmental consultant has assured us, based on computer models, that the toxic

leachate they show flowing directly towards local homes won't reach our wells and poison our drinking water. As someone whose well is fed by the Ruby aquifer, I am not reassured. Computer models also predict the weather, and as we all know, real-life doesn't always work out like the simulation. In my opinion, even considering putting a dump on top of an aquifer that feeds local wells and streams is very irresponsible. Imagine the cost of cleaning up leakage, even if it contaminates just a few wells and streams. Imagine the cost of MOE fines, of lawsuits for health and property damage. Imagine the threat to our local economy if the stigma of "polluted" is applied to Golden Lake. Do we really need to risk all that? Sebastopol opted to join Ottawa Valley Waste Recovery Centre when their dump threatened Lake Clear. Surely there's a lesson to be learned there.

John Hoffman,
R.R. 4, Killaloe

Council won't incur additional expense answering questions on Ruby waste site

Group hires consultant to review information about potential Ruby Road waste site

By Gerald Tracey
News Editor

Eganville -- Bonnechere Valley Township council will work as co-operatively as it can with a consultant retained by the Golden Lake Property Owners Association (GLPOA) to answer questions relating to the possibility of re-opening the Ruby Road waste site on the south shore of the lake, however council's position is that any additional costs will not be borne by township ratepayers.

The association recently hired a consultant from Sarnia to conduct a review of the technical documentation supporting the possibility of the township re-opening the Ruby Road site which would become the township's main site when the current Sand Road site is closed.

Wilf Ruland wrote the township asking for answers to a long list of questions relating to the project and while township CAO Bryan Martin has attempted to answer as many of the questions as possible, Mr. Ruland will have to sift through reports from Cambium Consultants, the Peterborough firm engaged by the township to do the waste site study.

Councillor Cairine Cybulski said at last Tuesday night's township council meeting that council's position is that it wants to incur the least cost possible in dealing with Mr. Ruland who, council believes, was retained to do a hydrogeology peer review.

However, Mr. Martin said he's not actually peer reviewing the documents that were provided to him.

"He started off looking at hydrogeology and now he's asking operational type questions that have no relevance as it relates to a hydrogeology review," he said. "I'm going to approach them (GLPOA) and see if I can't get more clarification on the scope of work that he has been employed for. Then some of the questions will be answered possibly by the consultant (Cambium) and some of them might be one word answers from me."

Coun. Cybulski said council doesn't want to have its consultant putting in all kinds of additional hours dealing with Mr. Ruland.

"Our ratepayers have already paid for the work," she said. "If there is information they (GLPOA) want and they deem it to be absolutely essential then I will go back and suggest they be responsible for the cost incurred."

Councillor Bob Peltzer said council is confident Mr. Martin can answer most of the questions being asked because they will be fairly succinct answers.

"Some of the questions might be very basically answered that that is not a question that is germane to the topic or the question at hand at this time," he said. "And that if we were presenting an operational plan or something of that nature some of

these questions might be germane but right now this is not a question that we are willing to have answered until such time that we decide this is going to go forward because we've made no decision whatsoever about this project even going forward."

Coun. Peltzer said a lot of the answers might be, "the question is premature".

Councillor Merv Buckwald said answers to many questions Mr. Ruland has asked are already contained in reports given to him. He added he is also asking questions about work being done on an adjoining property that has nothing to do with the township.

Mayor Zig Mintha said someone doesn't trust the township's consultants.

"And they go and get their own friend who is a friend of a friend and we're supposed to trust that," he said. "They don't trust our consultants, but we've got to trust them."

Coun. Peltzer suggested it was quite possible the person asking the questions is not completely open minded.

"He might have an agenda dictated by whoever has hired him," he said.

Coun. Peltzer said the township must continue with the process of finding an alternate to the Sand Road site and at least until the Ministry of the Environment determines whether or not the Ruby site is a viable alternative.

"And up to that point I'm not willing to go overboard answering questions unless I can be certain that the questions I am answering are legitimate questions that need to be answered to determining whether or not it is a viable site," he said. "I think you just have to deal with this kind of thing. It's to be expected. I understand where it's coming from and I think we try to deal with it politely and professionally but not necessarily open the cheque book."

Coun. Cybulski said the current council has bent over backwards trying to be open and transparent throughout the whole waste study process, going so far as to appoint individuals who had grave concerns about re-opening the Ruby Road site to the public liaison committee.

"Everything that council has had, they've had," she said.

Mayor-elect Jennifer Murphy, who was in the audience, said the GLPOA hired the consultant and as far as she was concerned, except for the very simple questions Mr. Martin can answer, "that's all they're getting".

"Bryan obviously furnished them with enough information to sink a ship, and he gave you back almost everything. Right? Well, do you know what? If he doesn't know how to read a report, then bully on him. Why should you or we pay Cambium to answer his questions. It's not happening," she said.

OVWRC remains most expensive option for BV Township

By Debbi Christinck
Staff Writer

Eganville — The ongoing examination of waste options for Bonchere Valley Township continues, with new figures released on Monday showing although costs have been adjusted for both the Ruby Road expansion option and the Ottawa Valley Waste Recovery Centre (OVWRC) and a third option to export to Lafleche has been added, the cheapest option for the municipality remains to expand the township waste site in South

Algonia Ward.

"This is a controversial process," admitted Councillor Bob Pelzer, who chaired the meeting. "Some people don't want a dump in their backyard; it is our obligation to look past the local sentiment and find the best waste management option and we hope people will respect that."

A lengthy meeting was held at the township office with consultants John Desbiens and Dave Buchholz from Cambium Environmental giving a presentation on the latest cost

figures for waste management in the township. Present were representatives from the Golden Lake Property Owner's Association (GLPOA), the OVWRC and the general public. The financial picture presented by Cambium has undergone a lot of scrutiny and consultation, including meetings with staff from the OVWRC, but the bottom line according to these drafts is the only option which will not bring with it an increase to taxpayers is to expand the Ruby Road site. Although the figures were agreed to in

principle by staff from the OVWRC, township CAO Bryan Martin added there was still a dispute over \$2 million in closing maintenance costs for the OVWRC which the township felt should be included.

"We don't agree with it, but we took it on," he said. "That includes long-term care operating costs and perpetual care."

Closing costs for the Ruby Road site were included in the figure. If the \$2 million was added in, the costs for the OVWRC would have jumped even

more, he said.

This is not the first time these figures have been released, but there has always been a great deal of discussion regarding their accuracy. In the latest figures the cost of the landfill option went up, and the cost of OVWRC went down, but exporting waste remained more expensive. The option of exporting waste to a facility at Moose Creek, near Cornwall, was examined in the study but the distance in transporting waste there was seen as a major liability especially if the price of gas goes up more than anticipated in the next 20 years.

At a cost of \$396 per tonne, the landfill expansion at Ruby Road would cost taxpayers \$126 per \$100,000 assessment. Mr. Martin pointed out taxpayers currently pay between \$120 and \$130 per \$100,000 assess-

See Page 18

The Lender, Eganville, Ontario - December 15, 2010

Joining OVWRC is the most expensive option for BV's waste

From Staff

OVWRC General Manager Sue McCrae, who was present at the meeting, said she thought the figures presented at the meeting were very close to what OVWRC felt were the actual figures, so it was a fair representation of the costs involved with joining the organization. BV is already an owner since it has a 1.97 per cent share in the business because the former Sebastopol Township was an original founding member and through amalgamation Bonchere Valley Township took that over. If BV was to buy in for the entire township it would have closer to a 10 per cent ownership share and liability at the OVWRC.

"The opening costs on all three options are contingent on inflation and transportation costs," BV Mayor Jennifer Murphy added.

Change In Figures

South Algonia resident Roger Inghoff, who owns Bonchere Lodge, said he was surprised to see the changes in the figures from earlier figures presented.

"The cost for the landfill has changed about 200 bucks and the

cost for the OVWRC went down by half," he said.

Mr. Martin said there still needs to be a realization that there will be \$75 million in closure costs at OVWRC and although the township is on the hook for two per cent of that, it could be on the hook for 10 per cent if the township chooses to buy in totally to OVWRC. He added the liability for this cost is disputed by OVWRC because they are setting aside money to cover this, however the fees it may not be enough to pay all the costs.

"We need to explore areas where figures can go wrong," Coun. Pelzer said, asking both the consultants from Cambium and Ms. McCrae to point out areas where these figures might later prove to be incorrect.

"The changing price of fuel can affect the total cost," said Mr. Buchholz. "Compliance issues, environmental issues can change the final cost."

Ms. McCrae said when they did their cost estimates it was based on the OVWRC breaking even each year, but a few years ago when the

cost for recyclables went down they had to go back to the partners for more funding. On good years profits go to the partners, she added. A leachate collection is also a big issue and would be so for either option, she said.

"The other thing which can affect this is the number of transfer sites," Mr. Martin said. "Having three transfer sites instead of five would be a change."

Another question is whether or not the OVWRC is even interested or available for BV to come in as a full partner, Mr. Buchholz added.

"The board has agreed that would be fine," Ms. McCrae said. In fact, provisions had been made for this even when the site was operating on an Emergency Certificate of Approval, she added.

"So we can see there are no impediments for us to move in either direction," Coun. Pelzer said.

Environmental Screening At Ruby Site

Mr. Desbiens gave an update on the proposed expansion at the Ruby site and said Cambium is continuing its study to see if expansion is

feasible.

"This is still only an option and we are just evaluating the feasibility of it," he said.

One of the reasons the site was chosen is because a waste operation already exists there, he said. There is also land to expand and favourable surface and subsurface conditions. Various studies have been completed on the site including traffic impact, aesthetic, environmental impact and hydro-geological impact.

"The last thing holding it up was the acceptance of the hydro-geological investigation," he said. "Now the ministry (Environment) is satisfied with the hydro-geological investigation."

A letter from the ministry said the consultants can proceed with completing the environmental screening process.

"Hydro-geological is the most important," Mr. Desbiens noted. "So they are very careful with their reviews; it takes a long time for them to review the documents and that is what we were waiting on."

Now all the studies show there

is no net effect that cannot be mitigated to an acceptable level, he added.

"An expansion would be designed to protect surface water and ground water," he said.

If the waste site was to expand there it would provide capacity for 25 years on a 2.5 hectare site within a 6.8 hectare buffer site.

If council determines this is a preferred option, the statement of completion on this study could be given to the ministry as early as summer 2011, Mr. Desbiens said.

Decisions Needed Soon

The township is going to have to make a decision soon on what to do with the waste, Mr. Buchholz said. Council there is about 6.4 years left in capacity in the township.

"That number seems to be a slippery one," Coun. Pelzer replied. "It seems four years ago we were told four years."

Mr. Buchholz said things change as new factors are adjusted like the volume and contents of the Sno-Drifters site. The township currently has two operating sites,

Sno-Drifters and Sand Road. Internals of waste diversions through recycling at the township is diverting about 33.6 per cent which is excellent for a rural municipality, he said. At a cost of \$346 per tonne for recycling, it also is much lower than the average cost of \$317 a tonne for similar municipalities with a large rural component, he added. Although council would like to see more garbage diverted from the landfill through recycling and composting, it is challenging to find where things can be improved, Coun. Pelzer said.

"We are already about 10 per cent above the average for similar municipalities in Ontario," he said. "How much more can we realistically do?"

Council will receive an update from the GLPOA when their consultant has completed a peer review of the waste options and study. All this information will be considered as the township moves forward, Coun. Pelzer said.

"We've never had a political agenda on this," he added. "We just want the facts."



Ruby Road Waste Site

Golden Lake Property Owners Association gets 'second opinion' on proposed Ruby Road Landfill

February 21, 2011

Prompted by concerns expressed by its members, the GLPOA Board of Directors contracted with professional hydrogeologist, Wilf Ruland, to conduct an [independent review](#) of the documents prepared for the Township of Bonnechere Valley in support of the proposed landfill site on Ruby Road. The GLPOA Board agreed that getting a second opinion on the matter was required to demonstrate due diligence on behalf of its members.

The GLPOA has been active on the Ruby Road site issue since it was first proposed. Some GLPOA members served on the Public Liaison Committee for the project, including members of its executive committee. The proposed waste site was hotly debated at the Association's 2008 Annual General Meeting, and it hosted a special public meeting in Killaloe on July 19, 2008 to ensure that its members and interested community members were fully informed of the issues.

Mr. Ruland is a specialist in landfill-related groundwater and surface water contamination issues, and has investigated many such issues over the course of his 25 year consulting career. In 1993 he co-authored a report commissioned by the Ontario Ministry of Environment on suggested guidelines for 'attenuation' landfill sites such as the one proposed for Ruby Road. His services came highly recommended by past clients.

In providing background to the Ruby Road landfill proposal, Mr. Ruland wrote in his review:

"The Township of Bonnechere Valley is proposing to build and operate a 2.5 hectare 'attenuation landfill' - this is the term used for a landfill with no facilities for collection or treatment of its leachate (the contaminated

liquid which forms when rainfall leaches contaminants out of the wastes).

If the landfill proposal is approved, the intention is for all of the proposed landfill's leachate to simply be allowed to leak into the ground. The assumption being made is that the leachate will all be "attenuated" (ie. filtered, absorbed, and diluted) on the proposed landfill property, with no offsite impacts occurring.

It is my position based on my review of the publicly available information that this assumption is not reasonable, and that the proposed landfill is likely to cause extensive and unacceptable off-site contamination of groundwater and/or surface water."

In the review document, Mr. Ruland explains the importance of controlling the release of landfill leachate into the environment:

"Leachate derived from modern municipal waste streams contains thousands of chemicals (Cherry et al, 1987). Many of these chemicals are harmless, but some are problematic if they get into the environment, and a few may be hazardous if present even in minute amounts. Thus landfill leachate is a noxious liquid which should not be ingested, and which should be prevented from coming into contact with plants, fish or animals in the natural environment."

The review goes on to describe the volume, rates of movement and direction of the groundwater leachate plume. Mr. Ruland concludes that the plume will have a greater volume and will travel considerably faster and further than the previous documentation suggests.

One aspect of the proposed site that will be of particular concern to property owners around Golden Lake is the presence of a flowing stream on the adjacent property immediately to the west and within about 100 metres of the proposed landfill site. As Mr. Ruland writes in his review, this stream was not correctly described in the documentation he reviewed:

"Drainage from the proposed landfill will be to the west toward an unnamed stream on the adjacent property which flows directly into Golden Lake. This stream

flows most of the year, but was reported to have standing water only on July 30, 2008.

Certainly this stream could provide an effective potential pathway for the rapid transport of contaminants from the landfill into Golden Lake - I estimate that travel times would be less than a day for any contamination which reaches the creek to be discharged into Golden Lake.

A major shortcoming of the hydrogeological investigation of the proposed landfill is the fact that this stream and the role it may play in causing contamination of Golden Lake has not been identified or assessed.”

One of the perceived advantages of the Ruby Road landfill option is that it would be less costly than alternatives, most notably the option of sending waste to the Ottawa Valley Waste Recovery Centre. In his review, Mr. Ruland raises issues that bear directly on the matter of cost:

“The currently available information about the landfill proposal has provided little disclosure about possible mitigation measures. The only explicit reference to possible mitigation measures I could find in public information made available by the Township is on page 31 of the September 20, 2010 Modelling report. The report simply lists the following possible mitigation measures:

- acquisition of additional land;
- applying a low-permeability clay cover to parts of the site which have reached final contours;
- installing a collection system consisting of purge wells and/or leachate collection pipes.”

He then goes on to point out:

“I expect that if mitigation measures as described above are required then the costs of this proposal will escalate to the point where it is more expensive than the alternatives. Thus it is critically important for the

Township to gain a better understanding now of whether such measures will be needed. As discussed earlier, it is my opinion that major mitigation measures will be needed.”

The GLPOA Board of Directors has spent a lot of time learning about the Ruby Road proposal and grappling with the difficult issues it raises. The Board has been careful from the outset to avoid criticism of the Bonnechere Valley Township Council, knowing that waste management issues and the establishment of landfill sites are subjects that all municipal councils across Ontario have struggled with. The investment GLPOA has made in hiring Mr. Ruland to review the documentation supporting the Ruby Road option is its contribution to assisting Council in making good public policy that it will be able to stand behind in the years to come.

“This has been a real learning experience for me,” said GLPOA President Kevin O’Connor. “I encourage everyone who wishes to be fully informed of the issue to read the entire review document”.

The [full report](#) (15 pages plus appendices) is available on the GLPOA web site.

For further information, please contact:

Kevin O’Connor, GLPOA President
Dave Lemkay, GLPOA Past-President
John Gulland, Chair, GLPOA Water Quality Committee

(Contact information is available in the ‘[About](#)’ section of the GLPOA web site at www.goldenlake.info)



Hydrogeologist critical of township information on proposed Ruby Road dump

By Debbi Christinck
Staff Writer

Golden Lake -- A report from the hydrogeologist hired by the Golden Lake Property Owners Association is accentuated with concerns about the proposed landfill at the Ruby Road Site near the lake, and differing opinions from those presented by Bonnechere Valley Township and the township's consultants.

"Overall the impression conveyed by my review of the publicly available information material is that at present the township does not have a good understanding of the hydrogeology of the proposed attenuation landfill location," hydrogeologist Wilf Ruland said in his report. "The site hydrogeology is very complex, and this complexity has not been adequately discussed in the materials issued in support of the proposed attenuation landfill to date."

Other comments were even more critical. He pointed out his own interpretation of the site hydrogeology "differs significantly from the interpretation of site hydrogeology provided in the township's information materials."

"There are significant implications arising from this disagreement -- namely the answer to the question of whether or not the proposed landfill site could be suitable for an attenuation landfill," he went on to state.

"Overall, I am concerned that this site is not nearly as suitable for an attenuation landfill as has been publicly suggested, and may in fact be unsuitable."

Mr. Ruland, who is from Dundas, Ontario and has 29 years experience as a hydrogeologist in Germany and Canada, also states the study into the landfill should not continue in the Environmental Screening Process because he feels steps have not been done adequately. He also states he has clear concerns about groundwater and surface water contamination with the proposed site.

"If the landfill proposal is approved, the intention is for all of the proposed landfill's leachate to simply be allowed to leak into the ground. The assumption being made is that the leachate will all be "attenuated" (ie. filtered, absorbed, and diluted) on the proposed landfill property, with no offsite impacts occurring," he said. "It is my position based on my review of the publicly available information that this assumption is not reasonable, and that the proposed landfill is likely to cause extensive and unacceptable off-site contamination of groundwater and/or surface water."

Because of concerns from some of the membership, the GLPOA Board of Directors contracted Mr. Ruland last year to do a review of the documents prepared for the Township of Bonnechere Valley concerning the proposed waste site. The response was made public last week and is available in its entirety on the GLPOA website.

According to a release by the board, the GLPOA has been active on the Ruby Road site issue since it was first proposed. Some GLPOA members served on the Public Liaison Committee for the project, including members of its executive committee. The proposed waste site was hotly debated at the association's 2008 Annual General Meeting, and it hosted a special public meeting in Killaloe on July 19, 2008 to ensure that its members and interested community members were fully informed of the issues.

According to the GLPOA, Mr. Ruland is a specialist in landfill-related groundwater and surface water contamination issues, and has investigated many such issues over the course of his 25 year consulting career.

In his review he expresses concern about the leachate possible with this new landfill. He maintains the leachate will travel faster and further than other studies have concluded. He is especially concerned about a stream within about 100 metres of the landfill, which he states was not properly identified or marked on previous studies.

"Drainage from the proposed landfill will be to the west toward an unnamed stream on the adjacent property which flows directly into Golden Lake," he said. "This stream flows most of the year, but was reported to have standing water only on July 30, 2008. "Certainly this stream could provide an effective potential pathway for the rapid transport of contaminants from the landfill into Golden Lake. I estimate that travel times would be less than a day for any contamination which reaches the creek to be discharged into Golden Lake."

Mr. Ruland also disagrees the cost of the Ruby Road site is cheaper than other options. His rationale is there is little disclosure about possible mitigation measures.

"I expect that if mitigation measures as described above are required then the costs of this proposal will escalate to the point where it is more expensive than the alternatives," he said. "Thus, it is critically important for the township to gain a better understanding now of whether such measures will be needed. As discussed earlier, it is my opinion that major mitigation measures will be needed."

Mr. Ruland was also critical of monitoring of the current Ruby Road waste site, stating there is contamination of nearby groundwater.

"The landfill is not in compliance with the MOE Reasonable Use Policy, and off-site contamination of private property is occurring," he maintains.

The GLPOA board did not make a recommendation on Mr. Ruland's comments.

"This has been a real learning experience for me," said GLPOA President Kevin O'Connor. "I encourage everyone who wishes to be fully informed of the issue to read the entire review document".

The full report is available on the GLPOA web site.

Building Supplies *Three great locations to serve your building needs*



Depot
anville

2011 Odyssey
Perfect for life.

"Get what you want"

1405 Pembroke St,
Pembroke

2011 Petter's Kawasaki

of J.D. D.

The Hamilton Leader

largest paid circulation newspaper

Independently-owned since

No. 39

Wednesday, March 16, 2011

Eganville, Ontario

(\$1.19 + 6 cents GST) \$1

**s family relieved
safe in Japan**



Expansion of Ruby Road site most cost efficient option for BV Township

Ruby Road site - \$10.3 million - Lafleche Environmental - \$11.2 million
Ottawa Valley Waste Recovery Centre - \$13.2 million

By Debbi Christinck
Staff Writer

Eganville -- A report by Bonnechere Valley Township consultants Cambium Environmental on the cost of various waste management options for the township shows costs will be going up for the township with any new option, but the most cost efficient option continues to be the expansion of the Ruby Road Site.

A comparison of the cost evaluation assessment for the three waste management scenarios indicates:

That "the most cost-effective approach to managing waste over a 25-year planning horizon is land-filling within the township through expansion of the Ruby Road waste disposal site at \$10.3 million," the report states. "The results of the cost evaluation assessment indicate that the Ruby Road waste disposal site expansion scenario would have a less significant impact on the township finances when compared to exportation to a private third party facility such as Lafleche Environmental near Cornwall at \$11.2 million or the Ottawa Valley Waste Recovery Centre in Laurentian Valley Township at \$13.2 million."

However, all these options are a bit more expensive than the current costs, according to the report. Current township waste operations are estimated to be \$356,743 annually, and opting with the Ruby Road expansion would cost \$402,029 annually. Exporting the waste to LaFleche Environmental would be \$447,992 annually and exporting to the Ottawa Valley Waste Recovery Centre would be \$544,514 annually.

For homeowners the impact per \$100,000 assessment would be \$132 for the Ruby Road expansion, \$178 for the OVWRC and \$146 for

Lafleche.

This is a study updating previous costing studies. The study looked at the costs of expansion of the Ruby Road waste disposal site, full membership of the Ottawa Valley Waste Recovery Centre (OVWRC) and exportation of waste to Lafleche Environmental.

This updated cost estimate includes costs for "those significant expenditures which are reasonably anticipated during the development, operational and closure periods" of the three options the township is looking at. The cost estimates include approvals, member fees, development, operation, including leachate management, maintenance and monitoring, closure, and post-closure monitoring and maintenance costs for each option.

The costs were based on the 2010 municipal budget information and information received from the OVWRC and Lafleche Environmental. The updated costs also include information from a report titled *Valuation of the Ottawa Valley Waste Recovery Centre* which determines the value of the OVWRC to be \$15,188,000 as of December 31, 2008. The report also includes more recent correspondence from the OVWRC as late as September 2010 on costing.

The report from Cambium takes into consideration site development costs, closure construction, and other respective costs within the planning period to provide the most representative cost projections for township waste disposal. For significant capital purchases financing, Cambium has calculated annual payments using a loan interest rate of 5% over an amortization period of 25 years.

In order to compare the total cash value of the three scenarios the present worth of the scenarios were

calculated. The present worth is the total amount that a series of future payments is worth now in 2010 dollars accounting for inflation and return on investment. The present worth calculations were completed using an annual interest rate of five percent and an inflation rate of two percent. The calculation utilizes a three-year period for approvals, followed by the 25-year site life, and 25 years of post-closure care.

This report was an update to the cost evaluation report which was presented five years ago by SGS Lakefield Research. In 2006 the report showed the cost associated with BV's existing waste management practices were lower than the Ontario municipal average for waste generation. The report also concluded the landfill alternative was the most cost effective and predictable solution. As well, expanding an existing site was seen as more suitable than developing a new or "Greenfield" site.

Existing System

The report presented an overview of the existing system as well. Currently the township has six waste disposal sites which include two active sites -- Sand Road and Eganville (Mink Lake) -- as well as four transfer stations -- Ruby Road, Lake Clear, McGrath Road and Highway 41. Household waste from the Highway 41 site and the Ruby Road site are currently disposed at Sand Road. Recyclables are transferred to the OVWRC. The total waste management operating costs for the township in 2010 were estimated to be \$356,743 or \$220 per tonne at an estimated 1623.1 tonnes per year.

According to the consultants, the population of the township was 3,665 in 2006 with an additional seasonal population of approximately 1,260

between June and August.

Landfill Expansion Cost

According to the report, cost for planning and engineering the landfill at the Ruby Road site would be \$110,100. This includes approvals for the expanded landfill and the upgraded transfer station. Initial capital costs for the Ruby site include the development of the landfill at \$475,962, as well as development of the transfer station at \$88,765. Also included is equipment used for compaction which is shared with the roads department and estimated at \$135,000 and progressive closure of the expanded landfill at \$533,600. Other costs include the closure of existing sites at \$534,500 and a contingency of \$163,283. Contract fees, with buy-in costs and royalties, add on another \$108,350.

The total costs for capital of the landfill expansion are \$2,039,459.

In terms of operating costs for the Ruby Road site, the total costs are \$7,926,424. This is broken down to the existing system costs which includes landfill, transfer and curb side costs of \$2,909,301. It also includes facility operating costs of \$1,266,564 and transfer station costs of \$2,258,880. The internal waste hauling costs are \$414,779 and the recycle material export costs are \$727,500. Post closure costs are placed at \$349,401.

Total costs for the Ruby Road site were \$1,075,983 with annual cost per tonne at \$229.

Costs at the Ruby Road site include land purchase, access roads, fencing, equipment and storage. There is also a provision for staffing, monitoring and equipment and general maintenance.

See Page 7

informed Michael's parents, were safe in Japan.

resented etition

ghout the first year. It's not to at there could not be changes in 's done in the future, but we are two months into this particular g regimen and council certainly to give it more time to see how ks and how people adjust their patterns."

n. Peltzer said he and his col-es appreciated that people were sted enough to let council know vere concerned about the new en.

do understand that. We cer-try to undertake to make certain is has the smallest impact that n have. But that being said we that there are going to be some es required in the way some use water. There will be some ments to make over time.

months doesn't give council time to look at the new billing od to make some intelligent es for the future, he added.

n. Peltzer said council respects etition and understands those igned it and are customers of rvices do have concerns.

do give us time and let us work the process and we will cer-make changes and adjustments s we see how it's going."

YSLER LTD.

JEEP RAM
ON

1-888-432-8532

etching fee

Renfrew Chrysler invites you to "Canada's Newest Showroom Event"
Saturday, March 19th - 9am - 4pm



Seeing is believing...that's why we're inviting you to our CANADA' NEWEST SHOWROOM EVENT on March 19th where you'll see and experience for yourself our full lineup of exciting vehicles.

Report challenging Ruby Road study based n

BV's waste study consultants respond to independent report paid for by Golden Lake Prop

It's frustrating when facts are overlooked or misunderstood.

-- Cambium Environmental President
John Desbiens

By Gerald Tracey
News Editor

Eganville -- A report from a hydro-geologist critical of the Ruby Road site being considered as a potential new waste site for Bonnechere Valley Township is based more on opinion than fact, but the consulting firm engaged by the township isn't ignoring the report in its entirety.

The Golden Lake Property Owners Association (GL-POA) engaged Wilf Ruland of Dundas to review material concerning the waste study carried out by Cambium Environmental Inc. of Peterborough and his conclusion was the township did not have a good understanding of the hydrogeology of the proposed attenuation landfill location and that the study into the landfill should not continue in the Environmental Screening Process (ESP) because he felt steps have not been adequately taken.

However, the Ministry of the Environment has given the green light to continue with the ESP for the Ruby Road site and barring any surprises in the near future, the site will likely be chosen for the township's new waste site.

In a waste management update to council last week, John Desbiens, president of Cambium Environmental, said the Ruland report had been reviewed, the concerns recognized and where they are valid they will be addressed in the Environmental Screening Report (ESR) due later this spring. He emphasized the fact the Ministry of the Environment (MOE) had given approval to proceed with the ESR on Ruby Road supported the scientific data gathered by his firm.

"Their (MOE) job is to protect the environment," Mr. Desbiens told council last Tuesday. "They have no vested interest whatsoever in having a landfill expansion at the site. They agreed with the modelling that was done."

Mr. Desbiens said the summary of MOE's findings with respect to the Ruby Road site is that there are no net effects that cannot be mitigated at an acceptable level.

"It is understood that there's going to be an impact," he told council. "It's just a matter of mitigating those impacts and the proposed expansion of the site should be regarded as being a feasible option for the township's waste management needs for the next 25 years."

Independent of Mr. Ruland's report, Mr. Desbiens said there are a few concerns people have had about the Ruby site. He said it was important to note the site would be designed to protect surface water and ground water resources.

"We are using designs that are meant to maintain the environmental standards of the province and it will be engineered and developed using real information gathered at the site -- hydro-geological and geological data," he said. "We are not pulling numbers out of thin air; we are using real numbers at the site."

When asked by Councillor Bob Peltzer to comment on Mr. Ruland's report, Mr. Desbiens said another public consultation event will serve to clarify some invalid data concerns that some of members of the public may have about the site.

"I don't want to dismiss these concerns but I think it's important to recognize the true risk of some of these things occurring and we're basing this just on the facts of what we're seeing there."

"And it's not for lack of effort, study, investigation and data collection that we come to these conclusions. It truly is based on detailed study and work."

"I can only say the (GLPOA) consultant was hired to do a job. It would appear that that job has been completed."

Having said that Mr. Desbiens, said he certainly had some questions about some of the statements made in the Ruland report.

"Unfortunately, there are some misdirections on even location of the proposed landfill expansion, suggesting it is on a ridge, which is not the case at all, it's going to be situated in a low spot," he said. "Talking about overburden, there are some focuses on certain areas, again outside of where the waste disposal area will actually be, so there seems to be a focus on things like leachate potentially moving west. There is no evidence that could occur."

Mr. Desbiens also questioned why the Ruland report would suggest his firm use literary values in its hydraulic studies when Cambium was actually instructed by MOE to use real values from the site.

Mr. Desbiens also stated it was non-factual to suggest there is a stream on the property of the proposed waste site.

"I think what you are seeing there is some silt collection and, of course, you get some ponding after rain events but it's ephemeral at best. It is by no means a stream."

"It is something we will continue to review and pay attention to but it has been recognized not to be a stream but to be an ephemeral drainage at best."



Councillors Jack Roesner and Bob Peltzer, Mayor Jennifer Murphy, CAO Bryan Martin and Councillors Ch... Environmental Inc. President John Desbiens, left, accompanied by Dave Bucholtz, Senior Project Manager,

More of A Critique

Coun. Peltzer said the Ruland report appears to be more of a critique of what Cambium has done in its study and also an attempt to find scenarios where information contained in the study could be incorrect.

"It is not saying it is incorrect, but where it possibly could be incorrect. He is doing this without commissioning his own studies, drilling holes and actually going back and redoing the science," he said.

Coun. Peltzer added Mr. Ruland basically was critiquing the science Cambium was doing in a highly critical way. He asked Mr. Desbiens if he could do the same to reports on other waste site studies.

"Is this something unique to the science you have done here or can all science in all waste site studies be questioned in a similar manner?" he asked.

Mr. Desbiens answered that question by saying it depended on how objective one was in reviewing a study.

"But if you have a bias when you go in, you are going to think that the bias is going to dictate how you would go about your critique and your review, and where you would focus. And if you are putting focus on certain things which are not even necessarily true, then yes, you can quote numbers, you can argue numbers however you like, but without a basis for them or without an actual reference for where those numbers come from . . ."

"I don't know how familiar every consultant out there is with hydro-geological modeling," he continued. "There was no request for the model itself in order to work with the model itself on appreciation that the model does do a water balance . . . nor is there an appreciation, I think, for a lot of the extremes that were incorporated into the model in order to check just how robust it is. The conditions that are projected into the model for the future are well outside of the reality you would expect."

Mr. Desbiens said his company would do its best to pick through the Ruland report and anything that does have validity to work it into the ESR.

"The attempt here perhaps was to provide some kind of scientific basis for it but it's difficult to come to an agreement with some of these points that are in the report based on the fact that there are facts that are in the hydro-geological modelling report which seem to be either ignored or just discounted for no basis," he said.

Mr. Desbiens said the Ruland review of Cambium's work delayed the process by five months.

"When we finally did receive the report and once you pick through, perhaps, some things that really aren't valid for argument, there do remain some things that we really should consider and continue to incorporate into the final ESR."

"There has to be a recognition here that this is a screening and that when we get into the design of the landfill, if that were to be the choice, there would be mitigation measures for a lot of these things."

"Certainly the MOE comes at it with a more objective, unbiased . . . just looking at the science. They want to be able to stand behind the science."

Mr. Desbiens said many points in the Ruland report may just be opinions and may remain opinions not based on fact.

"But as I say there is some value in having received the comment and report and we'll incorporate the useful bits into the ESR as it is finalized."

When asked by Mayor Jennifer Murphy if there was anything specific in the Ruland report that Cambium might pull out and try to mitigate some of the concerns, Mr. Desbiens said that although his firm did a detailed listing of the leachate characteristics, they may not have accentuated how they came to the leachate characteristics they did.

"What we did was survey all of the leachate characteristics from all of the landfill sites in the township with



John Desbiens told BV council last week the Ministry of the Environment's job is to project the environment and it has no vested interest in having a landfill expansion at the Ruby Road site.

the understanding that this is the leachate going into the sites and this is the leachate that is coming out," he explained. "I think this is a fairly decent representation and then we bump all of those numbers up and make them a worse case scenario."

"Perhaps we'll reiterate that and certainly we will focus on this quote, unquote stream to the west just to again satisfy the concerns of people that this isn't a rocket drain to Golden Lake, and help them understand there is a disconnect between these pondings and the actual groundwater. It just drains straight down."

Mr. Desbiens said there are contingencies that can be implemented, but he reiterated the biggest thing to remember is that the site would not impact users of the groundwater.

Mr. Desbiens admitted to having some frustrations with the Ruland report, adding he does not mind criticism, but that it's frustrating when facts are overlooked or misunderstood.

"That's the frustrating part," he said.

When asked by Coun. Peltzer if there was any option other than land filling, Mr. Desbiens replied there are always options if you have enough money.

"It's whether you are willing to dispose of it or make it somebody else's problem," he said. "At this point in time you either have to dispose of it locally or you ship it to somebody else and have them dispose of it."

Coun. Peltzer said the Ruby Road option was a valid one, adding all three options available to the township

**Top Notch
Heating**

Income Tax Preparation

Debbie Prince

1372 Red Rock Road
R. 5, Killaloe

more on opinion

erty Owners' Association

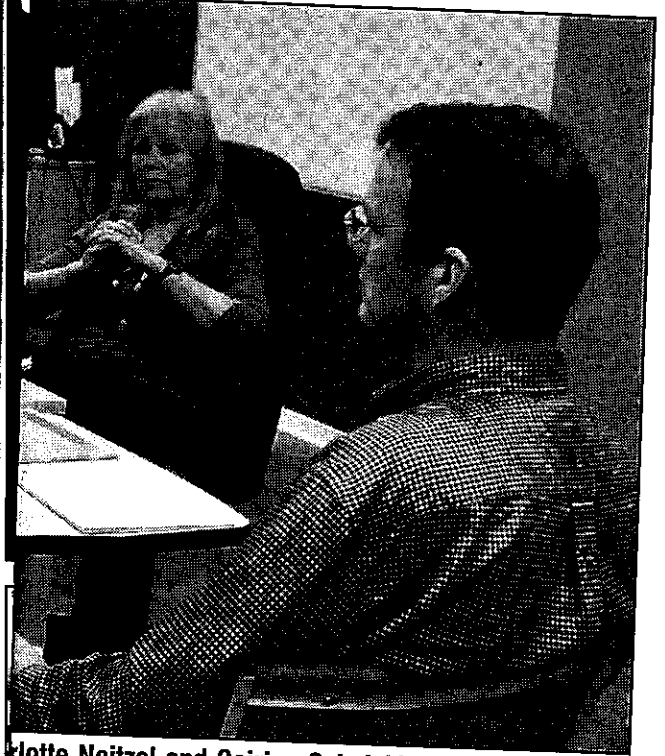

lotte Neitzel and Cairine Cybulski listen to Cambium respond to a study commissioned by the GLPOA.

involves disposing garbage in the ground.

Regardless, Mr. Desbiens said, the garbage will be disposed of in a landfill.

"There is obviously a regard for the environment here and it's a question of mitigating those impacts. But there always will be an impact, unless people stop producing waste."

He said one of the advantages of land filling today compared to 20 years ago is the number of practices implemented to reduce the amount of waste going into a landfill.

"We're talking about diverting a lot of material including organics, a lot of the plastics and even household hazardous waste. So what's going into these landfills is not what we're seeing in the landfills that have been created over the last 20 to 25 years."

Councillor Cairine Cybulski, in whose ward the potential landfill site is located, said council owed it to nearby residents and other concerned people that they do get counter answers to some of the claims in the Ruland report.

"When I read the report, people could suggest there was not due diligence done on our part," she said. "I think we are still trying to be very cautious in any decision that is made and to suggest it's just been carte blanche in sweeping any type of notion of caution to the wind is giving a false perception into everything."

"I want ratepayers to know that we are still doing our homework."

She said no one wants a waste site in their backyard, but added the bottom line is if Ruby Road is the choice, she will feel comfortable knowing contingencies are in place, that every *t* has been crossed and every *i* dotted, "and it will not have been done lightly if it does go that way."

Equal coverage sought

Dear Editor:

I am writing in response to your March 23, 2011 article entitled "*Report challenging Ruby Road study based more on opinion*". The article provided close to a full page of coverage of a "waste management update" provided to Bonnechere council by its consultant, John Desbiens regarding the proposed Ruby Road landfill site.

The article provided a comprehensive summary of the council's and its consultant's negative opinions about a report on the Ruby Road proposal which I had prepared for the Golden Lake Property Owners Association (GLPOA). Missing entirely from the article (or indeed from your paper to date) was any objective coverage of my original report, and the many concerns which I have raised about the proposed landfill. For your information, the full report is available on the GLPOA website.

I would invite you to give similarly detailed coverage to the scientifically based concerns which I have raised, as you have to the negative opinions expressed at the council meeting which you so extensively reported on. The scientific concerns which I have raised are based on the fact that Bonnechere council and its consultant are proposing to put a landfill on the Ruby Road site (near the location of a former gravel pit) without making any provision to collect and contain the contaminated liquids which will be flowing into groundwater and surface water from that site. I would welcome an opportunity to discuss these scientific concerns in detail for your readers.

In the meantime council should be

aware that it is required under the Environmental Screening Process to conduct further investigations in response to the substantive concerns which the GLPOA has brought to its attention through my report. It would be a mistake if, as reported in your article, council proceeds to have its consultant issue the Environmental Screening Report on the Ruby Road location later this spring without first conducting the additional investigations which I have recommended are necessary. If concerns are brought to the proponent's attention through the Environmental Screening Process, then under that process the proponent is required to conduct additional investigations. If council is planning on not following the requirements of the process (as your article suggests), then this could result in a later rejection of the Environmental Screening Report by the Ministry of the Environment.

I have done my best to provide a science-based review of the potential problems associated with the current Ruby Road landfill proposal, and the GLPOA has provided a valuable service to council in bringing these issues to its attention at this stage of the process. It is not too late at this point for council to do the right thing, and have its consultant carry out the recommended investigations.?

Wilf Ruland (P. Geo.)

Dundas, Ontario

Editor's note: The *Leader* gave ample coverage to the highlights of your report. However, we encourage everyone in the township to read it in its entirety by logging on to the GLPOA website. We believe we covered the significant points of the report.

RUBY LANDFILL FACTS



THE PROPOSAL – A NEW GARBAGE DUMP NEAR GOLDEN LAKE

The Township of Bonnechere Valley is looking for a long-term, low-cost solution to its waste disposal needs. Therefore it is proposing to dig a new landfill on an 80 acre site west of the now-closed Ruby dump. It claims that only 7.5 acres will be needed for the new landfill. It further claims that the site provides the perfect conditions for "natural attenuation" — that is, the environment will absorb all leakage of damaging chemicals and toxic substances (called 'leachate'). The Township believes that there is no risk to

area surface or groundwater (including wells), and no threat of contaminating Golden Lake in any of the 25 years that they propose to keep this new dump open. The Township also claims that there is no possibility of environmental damage. Accordingly, there are no plans for leachate containment, capture, or treatment. They have hired a Peterborough engineering firm, Cambium, to a contract amounting to several hundred thousand dollars, to oversee the approval process.

CONSIDER THE PROPOSED NEW RUBY LANDFILL / DUMP

- It is within one and a half kilometres of Golden Lake.
- It is to be an "old-fashioned" landfill — that is, the pit will not be lined, and there will be no capture or treatment of leachate (leakage). Leachate can contain mercury, cadmium, arsenic, and a host of other toxic chemicals and contaminants.
- The threat to the area would increase if, as suggested, construction materials and debris are also sent to this new dump.
- All dumps, even the safest most modern ones, leach after a period of time — 100% of them, according to Environment Canada.
- All landfills within Bonnechere Valley Township have already leaked to some extent.
- The cost of a new landfill (even an old-fashioned one) is not going to be cheap. Land must be purchased or leased, new equipment bought, and on-going monitoring set-up. A township study put the conservative capital and operating costs at hundreds of thousands of dollars per year, for decades to come.
- Should the monitoring process find that the dump is in fact leaking, the extra costs of clean-up could be very high, and a real burden to the taxpayer.
- Golden Lake contains numerous cottages and many businesses — a number of them geared to the tourist trade. These properties produce a lot of tax dollars for the Township, and the businesses help the Township's economy quite a bit. But tourists and new home & cottage buyers tend to react negatively to the idea of a nearby dump.

ARE THERE ALTERNATIVES? YES!

- Laurentian Valley Township operates a high-volume, up-to-date waste treatment facility nearby (Ottawa Valley Waste Recovery Centre on Wolto Station Road, near Rankin.)
- This waste recovery centre is currently constructing a leachate capture and treatment facility.
- Bonnechere Valley is already a partial partner in this facility, and could become a full member.
- The cost of joining the Ottawa Valley Waste Recovery Centre appears to be about equal to (or even less than) the cost of building a new landfill at Ruby.
- Plasma gasification of waste — which converts garbage into saleable commodities like electricity and aggregate — is on its way here; Ottawa looks likely to go this route, and Renfrew is now looking into it as well.
- The Township already owns and is operating a 50 acre landfill site which is apparently well short of capacity — which should give time for more consideration of more modern alternatives.

THE DEBATE :

Cambium and the Township contend that the new Ruby landfill will be safe, and that during the screening process, no alternatives should be considered. The Citizens for the Preservation of the Bonnechere Valley ask: "Why dig an old-fashioned — and dangerous — hole in the ground to dump waste into when better, safer solutions are available?"

WHAT DO YOU THINK?

You can express your view on this proposed new landfill at a public meeting which has been called for Saturday, July 26th, at 10 AM at the Legion ballfield park in Eganville.

AREA OF PROPOSED NEW LANDFILL

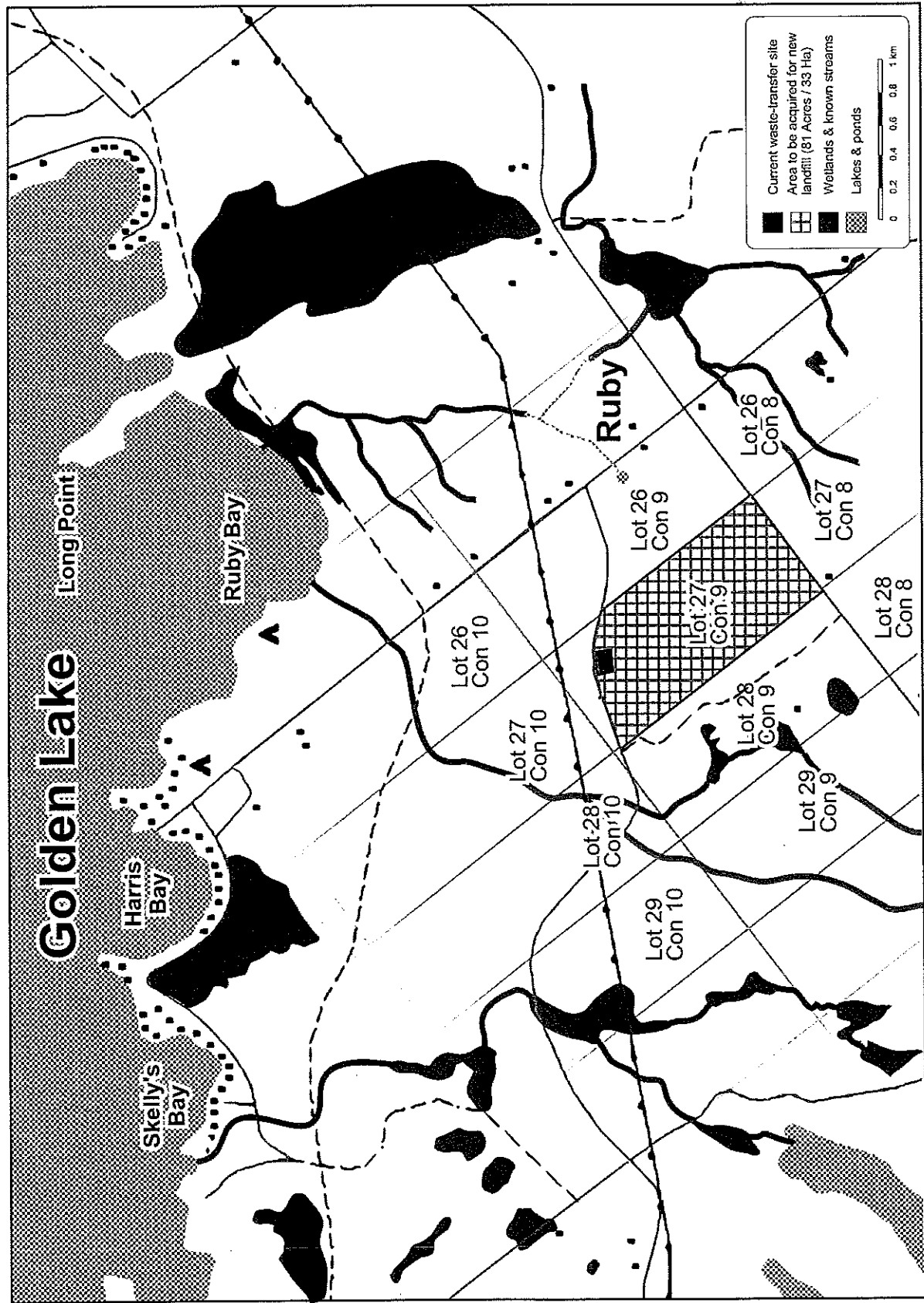

An open letter to the residents of Bonnechere Valley Township

As a business owner (Bonnechere Lodge) and long-time resident on Golden Lake I know how important it is to have a clean lake, not only for us, but for all businesses and residents around the lake. We all rely on good and clean water, from the lake and from the ground, and it would be extremely unwise to put that water at risk.

One of the Township of Bonnechere Valley's proposal is to build and operate a brand new 2.5 hectare "attenuation landfill" - this is the term used for a landfill with no facilities for capture or treatment of its leachate (the contaminated liquid which forms when rainfall leachate contaminants out of the wastes). The proposed location is barely a mile away from the lake!

When citizens first began to express their concerns about this old-fashioned approach to waste disposal, I was fortunate to become a member of Bonnechere Valley Township's Public Liaison Committee on waste management, to help council make its decision. Therefore, I have kept reminding them of facts and questions that must be addressed. Among the concerns:

Environmental Danger:

The Ministry of the Environment (MOE) has this to say about "attenuated landfills" on its website:

"Once the garbage gets to the landfill it is dumped and eventually covered by a layer of dirt. Some of it decomposes over time. Moisture and water can filter through the waste, picking up metals, minerals, organic chemicals, bacteria, viruses and other toxic materials. This contaminated water is called leachate. If the leachate is not contained, it can travel from the site and contaminate our ground and surface water."

After Cambium announced that its hydro-geologic studies showed no danger of the new leachate leaving the dump property, the Golden Lake Property Owners Association contracted Wilf Ruland, a respected hydro-geologist with 25 years experience, to provide a second opinion. He does not share Cambium's optimism. He contends that Cambium's testing was inadequate, that there are errors with respect to soil composition and the amount of surface water run-off, and that consequently, arch wells and Golden Lake itself are threatened with pollution.

In his report, he states:

"If the landfill proposal is approved, the intention is for all of the proposed landfill's leachate to simply be allowed to leak into the ground. The assumption being made is that the leachate will all be "attenuated" (ie. filtered, absorbed, and diluted) on the proposed landfill property, with no offsite impacts occurring. It is my position, that this assumption is not reasonable, and that the proposed landfill is likely to cause extensive and unacceptable off-site contamination of groundwater and/or surface water."

Although promised, the township has yet to answer Mr. Ruland's critiques.

In addition, MOE has identified underestimates of leachate leakage, and communicated these to the township, along with a clear warning of the need for more protective measures than currently planned - to quote:

"Our hydrogeologist expressed concern over the unverified properties of the proposed contaminant attenuation zone (CAZ) east of the theoretical fill area. Also requested was consideration of the possibility that actual leachate plume behaviour may differ from that predicted by the model. If leachate impacts become more widespread than predicted by the model, then mitigative measures will be necessary. The ministry requested in an email confirmation that the mitigative measures suggested in the report (CAZ enlargement, low permeability covers, leachate collection) are affordable and possible by the municipality"

The township apparently recognized these problems, as the ministry stated that: "Confirmation was provided by Cambium in an e-mail dated Nov. 25, 2010."

Cost Issues:

But although the township had admitted that it will have to take additional measures to protect residents against leachate contamination, it has so far failed to explain how much these measures will cost or how such expenditures would affect the overall project budget. Has the township estimated costs for these mitigative measures? If so, where are these costs reflected in the Ruby Road proposal? The figures presented on May 7, 2011 still show an unprotected landfill.

Also, what about recycling costs? If we build a new dump, Ottawa Valley Waste Recovery Centre (OVWRC) may no longer accept our recyclables

and compost. The next closest place is Beaumen Waste Management in Renfrew, but their future is uncertain. Does our township have a back-up plan? If so, what would be the costs? A full membership with the OVWRC would answer these questions!

Most important, how much would an "accident" cost? If the new dump does in fact leak, then the township could be on the hook for very large expenses over many years in retrofitting protection, and in paying damages. We can do better decisions for the generations to come!

Looking at the numbers, (Eganville Leader March 16, 2011) a full membership with the OVWRC would cost us \$46 more, going to Lafleche it is \$14 more per \$100,000 assessment in comparison with a new dump. This seems small numbers to pay for peace of mind. Of course, if the MOE-recommended extra protection measures are added to the new Ruby dump, its costs would no doubt exceed those for transportation, and there's no case for the landfill at all. And if there's ever an accident, the costs of the so-called "cheap" landfill would really soar!

Public Opinion:

The public has also spoken. As part of the mandatory public consultation under the Ministry's Environmental Screening Process, Bonnechere Valley Township (BVT) circulated two questionnaires (February and July 2008) about the proposed Ruby Road waste site to interested taxpayers. Between the two surveys, 100 responses were received. Of these 73% responded that they did not want a new dumpsite at Ruby and over 83% expressed serious concerns about the impact on ground and surface water. For a small township like BV, the concerns of this significant number of taxpayers should not be ignored.

I am confident that our council will respect Golden Lake and local property owners, as well as taxpayers' opinions, and make the right decision - which is to protect our surface and ground water. After all, they are deciding not just for current residents, but for the future of our next generation, since we manage the environment for them!

Roger Imhof
Public Liaison Committee
on Waste Management
Bonnechere Valley Township